

# Camper Van Price List Technical Data

VALID STARTING FROM JANUARY 1<sup>ST</sup> 2023

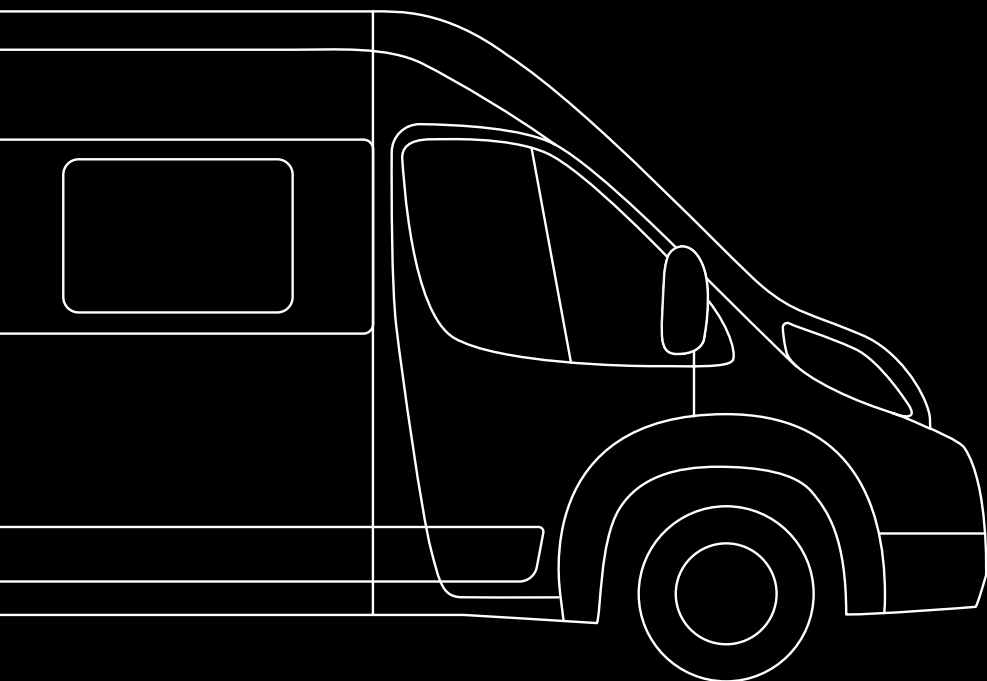

# IMPORTANT INFORMATION REGARDING THE SELECTION OF YOUR MOTORHOME

When buying a motorhome, camper van or urban vehicle (hereafter: motorhome), it is particularly important to choose the right layout and an appealing design. In addition, weight also plays an essential role. Family, friends, optional equipment, accessories and baggage – space must be available for all of these. At the same time, there are legal and technical limits to the configuration and load. Every motorhome is designed for a certain weight, which may not be exceeded during driving. For motorhome buyers, this raises the question: How should I configure my vehicle to accommodate passengers, baggage and accessories according to my needs without the vehicle exceeding this maximum weight? In order to make this decision easier for you, we provide you below with a few tips that are particularly important when selecting your vehicle from our portfolio:

## 1. The technically permissible maximum laden mass...

... is a value set by the manufacturer which the vehicle may not exceed. Laika specifies a layout-related upper limit for the vehicle, which can vary from layout to layout (e.g. 3,500 kg, 4,400 kg). You can find the corresponding specification for each layout in the technical data.

### KOSMO LOW-PROFILES OVERVIEW OF ALL MODELS



#### MODELS

		209	509
Standard chassis		Fiat Ducato 35 Light	Fiat Ducato 35 Light
Engine displacement / maximum power	cc / kW (hp)	2184 / 103 (140)	2184 / 103 (140)
External length / width / height <sup>(A)</sup>	cm	695 / 233 / 294	741 / 233 / 294
Internal width / height	cm	218 / 213	218 / 213
Wheelbase	mm	3.800	4.035
Technically permissible maximum laden mass*	kg	3.500	3.500
Mass in running order*	kg	2.876 (2.732 - 3.020)*	2.967 (2.819 - 3.115)*
Permitted number of seats (including driver)*		4 (S)	4 (S)
Manufacturer-specified mass for optional equipment*	kg	259	169
Technically permissible maximum towable mass* <sup>(B) (F)</sup>	kg	2.000	2.000

## 2. The mass in running order...

... consists – to put it simply – of the basic vehicle with standard equipment plus a standard weight of **75 kg for the driver**. It is legally permissible and possible for the mass in running order of your vehicle to deviate from the nominal value stated in the sales documents. The **permissible tolerance is ± 5 %**. The **permissible range** in kilograms is given in brackets after the mass in running order. In order to provide you with full transparency regarding possible weight deviations, Laika weighs each vehicle at the end of the line and informs your trade partner of your vehicle's weighing result for forwarding to you.

**Detailed explanations on the subject of mass in running order can be found in the “Legal Information” section.**

### 3. The permitted number of seats (including driver)...

... is determined by the manufacturer in what is referred to as the type-approval procedure. This results in what is referred to as the mass of the passengers. For this, a standard weight of 75 kg per passenger (without driver) is calculated.

Detailed explanations on the subject of mass of the passengers can be found in the “Legal Information” section

#### KOSMO LOW-PROFILES OVERVIEW OF ALL MODELS



#### MODELS

	209	509
Standard chassis	Fiat Ducato 35 Light	Fiat Ducato 35 Light
Engine displacement / maximum power	cc / kW (hp)	2184 / 103 (140)
External length / width / height <sup>(A)</sup>	cm	695 / 233 / 294
Internal width / height	cm	218 / 213
Wheelbase	mm	3.800
Technically permissible maximum laden mass*	kg	3.500
Mass in running order*	kg	2.876 (2.732 - 3.020)*
Permitted number of seats (including driver)*		4 (S)
Manufacturer-specified mass for optional equipment*	kg	259
Technically permissible maximum towable mass* <sup>(B) (P)</sup>	kg	2.000

### 4. The manufacturer-specified mass for optional equipment...

... is a value set by Laika per layout for the maximum mass of optional equipment that can be ordered. This limit is intended to ensure that the minimum pay-mass, i.e. the legally prescribed free mass for baggage and retrofitted accessories, is actually available for the vehicle load capacity of the vehicles delivered by Laika. If, in exceptional cases, the weighing at the end of the line nevertheless shows that the actual load capacity falls short of the minimum pay-mass due to a permissible weight deviation, we will check together with your trade partner and you whether we should, for example, increase the load capacity of the vehicle, reduce the number of seats or remove optional equipment before delivering the vehicle.

Detailed explanations on the subject of the effects of the tolerances on the minimum pay-mass and the payload can be found in the “Legal Information” section.

Code No.	Accessories	Price €	Kg*
<b>INTERIOR ACCESSORIES</b>			
F04	Electric drop-down bed above the lounge <sup>(B)</sup>	1770 €	40 kg
FC5	Bed conversion from single beds to double bed (with ladder)	350 €	12 kg
FD7	Seating group bed (single bed) and table with telescopic base	310 €	10 kg
TT6	Upholstery Verona	410 €	0 kg

**COMFORT PACK KOSMO** **PJ9**  
+ 12,5 KG\*

- Wooden footboard for shower tray
- Driver's cabin carpet and entrance mat
- Bathroom window <sup>(B)</sup>
- Insulated waste water tank

### 5. The additional weight of optional equipment and packages...

... increases the actual mass of the vehicle (= mass in running order plus selected optional equipment) and reduces the pay-mass. The specified value shows the additional weight compared to the standard equipment of the respective layout. The total weight of the selected packages and optional equipment must not exceed the manufacturer-specified mass for optional equipment.



# KOSMO CAMPER VAN EQUIPMENT

## CHASSIS

- Fiat Ducato, 140 BHP, Turbo Diesel Common Rail
- 16" steel wheel rims - Light chassis
- Fix & Go Tyre repair set
- 75 l fuel tank
- Electronic Stability Control: ESC, ABS, ASR, Hill Holder, Roll Over Mitigation, Crosswind Assist, Trailer Stability Control System, Post Collision Braking System
- Cruise control
- Eco-Pack with Start&Stop
- Manual air conditioning for cab
- Driver and passenger airbags
- Height adjustable steering wheel
- Electric windows in cab
- Electrically adjustable and heated exterior mirrors, with integrated indicator lights
- Bodywork and bumper painted in same colour

## CAB

- Central locking of cab and living area doors with remote control
- Height adjustable swivel cab seats with two armrests
- Unique feeling of space thanks to the increased interior height in the cab and above the lounge
- Storage compartments and indirect lighting inside front cab

## BODYWORK

- Floor and roof in XPS
- Load securing eyelets at back
- Rear bed can be easily dismantled to allow the loading of particularly bulky objects
- Windows with blind and mosquito nett

## KITCHEN

- Scratch and fingerprint resistant kitchen and table tops
- 2-burner stove and sink in stainless steel
- Compressor refrigerator
- Automatic soft-close drawers
- 230 V outlet in kitchen

## BATHROOM/SHOWER

- Clothes rail in bathroom
- Sliding toilet door
- Removable toilet cassette (antifreeze)
- Bathroom window
- 230 V outlet in bathroom

## SYSTEMS

- 100% LED lighting over and under wall units
- Indirect, dimmerable lighting
- Adjustable and repositionable reading lights on the rear bed and in the dinette
- Gas combi heating with heat distribution throughout the interior, including rear garage and driver's cabin
- Heating with programmable digital control panel
- Control panel with LED display
- Automatic 18 A battery charger
- Living area battery (95 Ah)
- USB sockets for power supply and charging of mobile devices
- Gas compartment for two cylinders
- Internal water tank, easily accessible for cleaning and inspection, complete with electric immersion pump
- Waste water tank featuring safety open/close button

## INTERIOR & COMFORT

- Furniture design "Pero Toscano"
- "Como" upholstery
- Lounge cushions with removable lining
- Height-adjustable living room headrests
- Isofix attachments (2 places)
- Extendable table
- Double floor with courtesy light and storage space in living area
- Maxi panoramic roof-light above the lounge <sup>(8)</sup>
- Beds with wooden slats
- Removable vertical partition panel between passenger compartment and loading compartment
- High comfort mattresses with machine washable stretch lining

# KOSMO CAMPER VAN OVERVIEW OF ALL MODELS

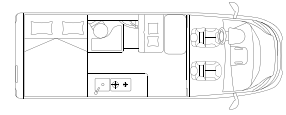
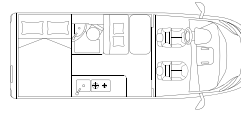

## MODELS

### 5.4

### 6.0

Standard chassis <sup>(46)</sup>	Fiat Ducato 35 Light	Fiat Ducato 35 Light
Engine displacement / maximum power	2184 / 103 (140)	2184 / 103 (140)
External length / width / height <sup>(A) (B)</sup>	541 / 205 / 270	599 / 205 / 270
Internal width / height	195 / 190	195 / 190
Wheelbase	3.450	4.035
Technically permissible maximum laden mass*	3.500	3.500
Mass in running order*	2.641 (2.509 - 2.773)*	2.748 (2.611 - 2.885)*
Permitted number of seats (including driver)*	4 (S)	4 (S)
Manufacturer-specified mass for optional equipment*	515	402
Technically permissible maximum towable mass* <sup>(E) (F)</sup>	2.500	2.500
Berths	2 (S) + 1 (O) + 2(O)	2 (S) + 1 (O) + 2(O)
Windows	5 (S) + 1 (O)	5 (S) + 1 (O)
70 x 50 cm panoramic roof-light in living area <sup>(4)</sup>	S	S
40 x 40 cm roof-light in sleeping area <sup>(4)</sup>	S	S
Fresh water tank capacity, total / Fresh water tank capacity at driving filling <sup>(D)</sup>	100 / 20	100 / 20
Maximum waste water tank capacity depending on configuration and actual load	90	90
Toilet with removable tank (antifreeze)	18	18
Double rear bed	195x133 / 130	195x157 / 150
Dinette bed	180x80 (O)	180x80 (O)
Bed on pop-top roof	206x143 (O)	206x143 (O)
Refrigerator	70	90
Hot air channeled heating system	6	6
12 V socket - 230 V sockets	1 / 3	1 / 3
USB socket	1	1
Storage space for gas cylinder with max. 11 kg filling weight	2	2

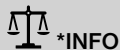

The specified **mass in running order** is a default value defined in the type-approval procedure. Due to manufacturing tolerances, the actual weighed mass in running order may deviate from the value stated above. Deviations of up to  $\pm 5\%$  of the mass in running order are legally permissible and possible. The permissible range in kilograms is given in brackets after the mass in running order. **The manufacturer-specified mass for optional equipment** is a calculated value for each type and layout that Laika uses to determine the maximum weight available for factory-fitted optional equipment. The limitation of optional equipment is intended to ensure that the minimum pay-mass, i.e. the legally prescribed free mass for baggage and retrofitted accessories, is actually available for the vehicle load capacity of the vehicles delivered by Laika.

The real weight of your vehicle ex works can only be determined

when it is weighed at the end of the line. If, in exceptional cases, the weighing shows that the actual load capacity falls below the minimum pay-mass despite limiting the optional equipment due to a permissible weight deviation, we will check together with your trade partner and you whether we should, for example, increase the load capacity of the vehicle, reduce the number of seats or remove optional equipment before delivering the vehicle. **The technically permissible maximum laden mass** of the vehicle and the **technically permissible maximum mass** on the axle must not be exceeded.

Detailed information & explanations on the subject of weight and the configuration of the vehicle can be found in the section Legal information. For a more detailed description of all mandatory technical dependencies, please refer to the explanations on the footnotes on p. 20.

# KOSMO CAMPER VAN

## OVERVIEW OF ALL MODELS



### MODELS

### 6.4

Standard chassis <sup>(46)</sup>		Fiat Ducato 35 Light
Engine displacement / maximum power	cc / kW (hp)	2184 / 103 (140)
External length / width / height <sup>(A) (B)</sup>	cm	636 / 205 / 270
Internal width / height	cm	195 / 190
Wheelbase	mm	4.035
Technically permissible maximum laden mass*	kg	3.500
Mass in running order*	kg	2.824 (2.683 - 2.965)*
Permitted number of seats (including driver)*		4 (S)
Manufacturer-specified mass for optional equipment*	kg	317
Technically permissible maximum towable mass* <sup>(E) (F)</sup>	kg	2.500
Berths		2 (S) + 1 (O) + 2(O)
Windows		5 (S) + 1 (O)
70 x 50 cm panoramic roof-light in living area <sup>(4)</sup>		S
40 x 40 cm roof-light in sleeping area <sup>(4)</sup>		S
Fresh water tank capacity, total / Fresh water tank capacity at driving filling <sup>(D)</sup>	l	100 / 20
Maximum waste water tank capacity depending on configuration and actual load	l	90
Toilet with removable tank (antifreeze)	l	18
Double rear bed	cm	195x185 / 188
Dinette bed	cm	180x80 (O)
Bed on pop-top roof	cm	206x143 (O)
Refrigerator	l	90
Hot air channeled heating system	kW	6
12 V socket - 230 V sockets	pcs.	1 / 3
USB socket	pcs.	1
Storage space for gas cylinder with max. 11 kg filling weight	pcs.	2

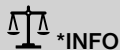

The specified **mass in running order** is a default value defined in the type-approval procedure. Due to manufacturing tolerances, the actual weighed mass in running order may deviate from the value stated above. Deviations of up to  $\pm 5\%$  of the mass in running order are legally permissible and possible. The permissible range in kilograms is given in brackets after the mass in running order. **The manufacturer-specified mass for optional equipment** is a calculated value for each type and layout that Laika uses to determine the maximum weight available for factory-fitted optional equipment. The limitation of optional equipment is intended to ensure that the minimum pay-mass, i.e. the legally prescribed free mass for baggage and retrofitted accessories, is actually available for the vehicle load capacity of the vehicles delivered by Laika.

The real weight of your vehicle ex works can only be determined

when it is weighed at the end of the line. If, in exceptional cases, the weighing shows that the actual load capacity falls below the minimum pay-mass despite limiting the optional equipment due to a permissible weight deviation, we will check together with your trade partner and you whether we should, for example, increase the load capacity of the vehicle, reduce the number of seats or remove optional equipment before delivering the vehicle. **The technically permissible maximum laden mass** of the vehicle and the **technically permissible maximum mass** on the axle must not be exceeded.

Detailed information & explanations on the subject of weight and the configuration of the vehicle can be found in the section Legal information. For a more detailed description of all mandatory technical dependencies, please refer to the explanations on the footnotes on p. 20.

# KOSMO CAMPER VAN PACKS

## CHASSIS PACK 2GA + 2,6 KG\*

- Steering wheel radio controls
- DAB radio antenna
- DAB car radio and speaker arrangement in cab
- Traction+, Hill Descent

Price

700 €

## COMFORT PACK 2K9 + 15,9 KG\*

- Cab seat upholstery
- Reversing camera preparation
- Shower cabin with curtain
- Mosquito net
- Wooden platform for shower tray
- Insulated waste water tank

Price

1.350 €

## CHASSIS DESIGN PACK PDN + 1 KG\*

- Glossy black engine grille
- Leather-covered steering wheel and gear knob, original Fiat
- Headlights with black design surround
- Dashboard in "Techno Trim" version

Price

620 €

## DRIVING ASSISTANCE SYSTEMS PACK 2PP + 0,2 KG\*

- Autonomous Emergency Brake Control with Pedestrian and Cyclist detection, Lane Control (Lane Support System), Rain and Dusk Sensor, Traffic Sign Recognition + High Beam Recognition

Price

950 €

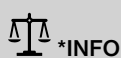

The factory installation of optional equipment increases the actual mass of the vehicle and reduces the pay-mass. The additional weight indicated for packages and optional equipment shows the additional weight compared to the standard equipment of the respective model or layout.

The total weight of the selected optional equipment must not exceed the **manufacturer-specified mass for optional equipment** shown in the model overviews. This is a calculated value for each

type and layout that Laika uses to determine the maximum weight available for factory-fitted optional equipment. Detailed information and explanations on the subject of weight can be found in the Legal information section.

For a more detailed description of all mandatory technical dependencies, please refer to the explanations on the footnotes on p. 20.



**ALARM PACK** **P5S**  
**CAMPER VAN** + **3,8 KG\***

- Parking sensors front (4 pieces)
- Rear parking sensors (4 pcs.)
- Volumetric-perimeter anti-theft device (incl. garage doors and hatches), remote control integrated in engine key

Price

**1.560 €**

**MULTIMEDIA PACK** **MM3**  
**KOSMO** + **7,8 KG\***

- Multimedia System 8", DAB car radio, Touchscreen, Navigation and map update 3 years, speakers, rear view camera <sup>(29)</sup> <sup>(41)</sup>

Price

**1.890 €**

**DIGITAL PACK** **PDC**  
**CAMPER VAN** + **4 KG\***

- 10" Radio UConnect, Full Digital Cluster, Rear digital camera FIAT <sup>(28)</sup> <sup>(29)</sup>

Price

**2.630 €**

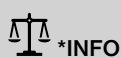

The factory installation of optional equipment increases the actual mass of the vehicle and reduces the pay-mass. The additional weight indicated for packages and optional equipment shows the additional weight compared to the standard equipment of the respective model or layout.

The total weight of the selected optional equipment must not exceed the **manufacturer-specified mass for optional equipment** shown in the model overviews. This is a calculated value for each

type and layout that Laika uses to determine the maximum weight available for factory-fitted optional equipment. Detailed information and explanations on the subject of weight can be found in the Legal information section.

For a more detailed description of all mandatory technical dependencies, please refer to the explanations on the footnotes on p. 20.

# KOSMO CAMPER VAN ACCESSORIES

Code No.	Accessories	Price €	Kg*	5.4	6.0	6.4
3051266	Fiat Ducato Heavy Chassis 3,500 kg*	1.240 €	40 kg	-	0	0
<b>CHASSIS AND CAB</b>						
632+6WH	"Metallic Black" metallic cab paint	1.040 €	0 kg	0	0	0
385+3YM	"Lanzarote Grey" cab paint	1.040 €	0 kg	0	0	0
676+9YB	"Expedition Grey" cab paint	1.040 €	0 kg	0	0	0
3389509	Fiat 2.2 Engine, 180 BHP, Euro 6d Final (Extra charge compared to 140 BHP)	3.450 €	20 kg	-	0	0
3350311	Fiat 2.2 Engine, 140 BHP, Heavy Duty (Extra charge compared to 140 BHP)	1.390 €	0 kg	0	-	0
3389514	Fiat 2.2 Engine, 180 BHP, Heavy Duty (Extra charge compared to 140 BHP) <sup>(3)</sup>	3.520 €	20 kg	-	-	0
2JH-5	Automatic transmission for 140 BHP engine - Light chassis <sup>(30)</sup>	3.290 €	55 kg	0	0	0
2JH-6	Automatic transmission for 180 BHP engine - Light chassis <sup>(30)</sup>	3.290 €	35 kg	-	0	0
AT9-HE140B	140 BHP Automatic gearbox for Heavy Chassis	3.290 €	18 kg	-	0	0
AT9-HE180B	180BHP Automatic gearbox for Heavy Chassis	3.290 €	3 kg	-	0	0
XAN	Blind Spot Assist + Rear Cross Path Detection <sup>(16)</sup>	630 €	1 kg	0	0	0
320	Steering wheel and gear knob in genuine leather, Fiat original part	330 €	0,3 kg	0	0	0
5QD	Engine battery cut off switch, Fiat original part	200 €	0 kg	0	0	0
3065127	Diesel tank 90 l, Fiat chassis	90 €	12 kg	0	0	0
FO7	Laika logo stickers for Fiat wheel covers or alloy wheels (4 pieces)	50 €	0,1 kg	0	0	0
431-2	16" Alloy wheels, Fiat original parts, 35 Light chassis (4 pieces)	620 €	0 kg	0	0	0
0R2-2	16" Alloy wheels black matte, Fiat original parts, 35 Light chassis (4 pieces)	710 €	0 kg	0	0	0
1LR	16" Alloy wheels Fiat original parts, Heavy chassis (4 pieces)	620 €	0 kg	0	0	0
LPZ	Fog lights with cornering function, Fiat original part	300 €	2 kg	0	0	0
LM1	LED daytime running lights, original Fiat	460 €	0 kg	0	0	0
9WE	Full LED headlights, Fiat original part	1.710 €	0 kg	0	0	0
026	Electric parking brake, Fiat original part	520 €	0 kg	0	0	0
52X	Provision for gasoline heating on Fiat chassis	110 €	3,5 kg	0	0	0
67333	Automatic cab air conditioning, Fiat original part	440 €	0 kg	0	0	0
RFX	Wireless charger for mobile phones - Fiat original part <sup>(47)</sup>	560 €	0 kg	0	0	0
365	TPMS tyre pressure checking system	240 €	0,5 kg	0	0	0
2064193	Rear double-blade suspensions, Fiat original parts	110 €	0 kg	0	0	0
C93	Internal sliding blind for windshield and cab windows	580 €	4,5 kg	0	0	0
508	Rear parking sensors (4 pieces)	330 €	0 kg	0	0	0
341	Automatically folding exterior mirrors	270 €	1 kg	0	0	0
GRG	9" Digital rear-view mirror	1.830 €	0,5 kg	0	0	0
FH7	Carpeted driver's cabin	240 €	3 kg	0	0	0

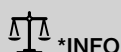

The factory installation of optional equipment increases the actual mass of the vehicle and reduces the pay-mass. The additional weight indicated for packages and optional equipment shows the additional weight compared to the standard equipment of the respective model or layout. The total weight of the selected optional equipment must not exceed the **manufacturer-specified mass for optional equipment** shown in the model overviews. This is a calculated value for each type and layout that Laika uses to determine the maximum weight available for factory-fitted optional equipment. Detailed information and explanations on the subject

of weight can be found in the Legal information section.

An increase of load capacity increases the manufacturer-specified mass for optional equipment. The increase results from the higher pay-mass due to the alternative chassis. The increased tare weight of the alternative chassis and, in particular, the weight for any mandatory heavier engine variants (e.g. 180 hp) must be deducted from this.

For a more detailed description of all mandatory technical dependencies, please refer to the explanations on the footnotes on p. 20.

Code No.	Accessories	Price €	Kg*	5.4	6.0	6.4
<b>INTERIOR ACCESSORIES</b>						
TFP	White pop-top roof with comfort double bed <sup>(4) (B) (C)</sup>	3.830 €	150 kg	O	O	O
TPG	Painted pop-top roof with comfortable double bed <sup>(4) (10) (B) (C)</sup>	4.500 €	150 kg	O	O	O
C73	Bed conversion seating group (single bed)	350 €	3 kg	O	O	O
TT6	Upholstery Verona	430 €	0 kg	O	O	O
EE	Upholstery Firenze, leatherette	610 €	0 kg	O	O	O
TT2	Upholstery Udine, leatherette	620 €	0 kg	O	O	O
TT5	Upholstery Milano, real leather	2.660 €	0 kg	O	O	O
C47	Preparations for 12V TV cable and TV bracket	290 €	3 kg	O	O	O
C72	19" TV LED DVD, with decoder and TV stand	880 €	8 kg	O	O	O
FB3	Upgrade from Combi 6 to Combi 6 E heating	400 €	3 kg	O	O	O
D42	Upgrade from Combi 6 to Combi Diesel heating <sup>(23)</sup>	610 €	1 kg	O	O	O
FH6	Upgrade from Combi 6 to Combi Diesel E heating <sup>(25)</sup>	1.260 €	5 kg	O	O	O
C12	Gas oven	560 €	14 kg	-	O	O
C78	Additional battery 90 Ah	430 €	26 kg	O	O	O
FL2	Gas detection system	200 €	2 kg	O	O	O
C74	Heated waste water tank	540 €	1 kg	O	O	O

## EXTERIOR ACCESSORIES

C77	Electrically operated entrance step	430 €	11 kg	O	O	O
C69	Rear window left side	480 €	5 kg	O	O	-
D14	Framed windows	370 €	5 kg	O	O	O
2837302	Tow hitch	1.050 €	50 kg	O	O	O
FH4	Switchover pressure gas regulator with remote control	300 €	1 kg	O	O	O
D39	Bicycle rack for 2 bikes	530 €	9,5 kg	O	O	O
OC4	Awning Laika, 3,2 m, anthracite housing	920 €	24 kg	O	-	-
C83	Awning Laika, 3,7 m, anthracite housing	1.000 €	28,5 kg	-	O	-
FQ1	Awning Laika, 4,0 m, anthracite housing	1.090 €	30 kg	-	-	O
C79	Provision for solar panel <sup>(6)</sup>	130 €	2 kg	O	O	O

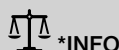

The factory installation of optional equipment increases the actual mass of the vehicle and reduces the pay-mass. The additional weight indicated for packages and optional equipment shows the additional weight compared to the standard equipment of the respective model or layout. The total weight of the selected optional equipment must not exceed the **manufacturer-specified mass for optional equipment** shown in the model overviews. This is a calculated value for each type and layout that Laika uses to determine the maximum weight available for factory-fitted optional equipment. Detailed information and explanations on the subject

of weight can be found in the Legal information section. An increase of load capacity increases the manufacturer-specified mass for optional equipment. The increase results from the higher pay-mass due to the alternative chassis. The increased tare weight of the alternative chassis and, in particular, the weight for any mandatory heavier engine variants (e.g. 180 hp) must be deducted from this. For a more detailed description of all mandatory technical dependencies, please refer to the explanations on the footnotes on p. 20.



# ECOVIP CAMPER VAN EQUIPMENT

## CHASSIS

- Fiat Ducato, 140 BHP, Turbo Diesel Common Rail
- 16" steel wheel rims - Light chassis
- Fix & Go Tyre repair set
- 75 l fuel tank
- Electronic Stability Control: ESC, ABS, ASR, Hill Holder, Roll Over Mitigation, Crosswind Assist, Trailer Stability Control System, Post Collision Braking System
- Cruise control
- Eco-Pack with Start&Stop
- Manual air conditioning for cab
- Driver and passenger airbags
- Height adjustable steering wheel
- Electric windows in cab
- Electrically adjustable and heated exterior mirrors, with integrated indicator lights
- Bodywork and bumper painted in same colour

## CAB

- Central locking of cab and living area doors with remote control
- Height-adjustable swivel cab seats with armrests, backrests and fabrics matched to the living area
- Lounge seating group
- Unique feeling of space thanks to the increased interior height in the cab and above the lounge
- Storage compartments and indirect lighting inside front cab

## BODYWORK

- Floor and roof in XPS, walls and roof insulated with Alu-Ecofiber
- Insulated rear doors and side door
- Load securing eyelets at back
- Rear bed can be easily dismantled to allow the loading of particularly bulky objects
- Vertical partition panel between passenger compartment and load compartment with removable door for internal access
- Windows with frame, flat window pane, blind and mosquito net

## KITCHEN

- Scratch and fingerprint resistant kitchen and table tops
- Indirect lighting under kitchen top
- 2-burner stove and sink in stainless steel
- Compressor refrigerator
- Automatic soft-close drawers
- 230 V outlet in kitchen

## BATHROOM/SHOWER

- Sliding toilet door
- Removable toilet cassette (antifreeze)
- Roof-light in bathroom
- Vario-bathroom with integrated separable maxi shower (depending on model)
- Bathroom window
- 230 V outlet in bathroom

## SYSTEMS

- 100% LED lighting over and under wall units
- Indirect, dimmerable lighting
- Adjustable reading lights complete with USB sockets
- Gas combi heating with heat distribution throughout the interior, including rear garage and driver's cabin
- Diesel combi heating with heat distribution throughout the interior <sup>(40)</sup>
- Heating with programmable digital control panel
- Control panel with LED display
- Automatic 18 A battery charger
- Living area battery (95 Ah)
- USB sockets for power supply and charging of mobile devices
- Gas compartment for two cylinders
- Internal water tank, easily accessible for cleaning and inspection, complete with electric immersion pump
- Waste water tank featuring safety open/close button
- Exhaust pipes with anti-odour siphons, recovery tank complete with external vent

## INTERIOR & COMFORT

- Insulated/upholstered ceiling
- Insulated/upholstered walls
- Anti-condensation walls and ventilation in the furniture for an ideal spread of the heat
- Furniture available in two designs: "Rovere Moka" (S), "Pero Toscano" (O)
- Height-adjustable living room headrests
- Ergonomic living room cushions with removable covers, seats, backrests and decoration cushions that can be arranged as desired
- "Parma" upholstery
- "Toscana" backrests
- Isofix attachments (1 place)
- Extendable table
- Double floor with courtesy light and storage space in living area
- Rear double floor
- Maxi panoramic roof-light above the lounge <sup>(8)</sup>
- Beds with wooden slats
- Back "Ergonomic" high comfort, anti-mite, breathable mattresses with machine washable stretch lining
- Design rear headboard
- Storage compartments inside the overcab
- TV compartment in living room with peninsula and indirect lighting

## STANDARD SETTINGS FOR:

- TV preparation with power supply and aerial cable
- TV in rear area <sup>(40)</sup>

# ECOVIP CAMPER VAN

## OVERVIEW OF ALL MODELS

### MODELS

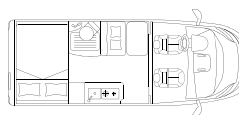

540

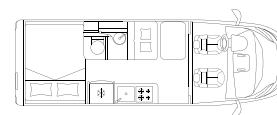

600

Standard chassis <sup>(46)</sup>		Fiat Ducato 35 Light	Fiat Ducato 35 Light
Engine displacement /maximum power	cc / kW (hp)	2184 / 103 (140)	2184 / 103 (140)
External length / width / height <sup>(A)</sup>	cm	541 / 205 / 270	599 / 205 / 270
Internal width / height	cm	195 / 190	195 / 190
Wheelbase	mm	3.450	4.035
Technically permissible maximum laden mass*	kg	3.500	3.500
Mass in running order*	kg	2.728 (2.592 - 2.864)*	2.875 (2.731 - 3.019)*
Permitted number of seats (including driver)*		4 (S)	4 (S)
Manufacturer-specified mass for optional equipment*	kg	428	270
Technically permissible maximum towable mass* <sup>(E) (F)</sup>	kg	2.500	2.500
Berths		2 (S) + 2 (O)	2 (S) + 2 (O)
Windows		5 (S) + 1 (O)	5 (S) + 1 (O)
70 x 50 cm panoramic roof-light in living area		S	S
40 x 40 cm roof-light in sleeping area		S	S
Fresh water tank capacity, total / Fresh water tank capacity at driving filling <sup>(D)</sup>	l	100 / 20	100 / 20
Maximum waste water tank capacity depending on configuration and actual load	l	90	90
Toilet with removable tank (antifreeze)	l	18	18
Rear right side bed / rear left side bed	cm	-	-
Double rear bed	cm	196x132 max / 120 min	196x150 max / 138 min
Bed on pop-top roof	cm	206x143 (O)	206x143 (O)
Refrigerator	l	70	90
Hot air channeled heating system	kW	6	6
12 V socket - 230 V sockets	pcs.	1 / 2	1 / 2
USB socket	pcs.	1+1	1+1
Storage space for gas cylinder with max. 11 kg filling weight	pcs.	2	2
Storage space for gas cylinder with max. 5 kg filling weight	pcs.	-	-

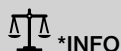

The specified **mass in running order** is a default value defined in the type-approval procedure. Due to manufacturing tolerances, the actual weighed mass in running order may deviate from the value stated above. Deviations of up to  $\pm 5\%$  of the mass in running order are legally permissible and possible. The permissible range in kilograms is given in brackets after the mass in running order. **The manufacturer-specified mass for optional equipment** is a calculated value for each type and layout that Laika uses to determine the maximum weight available for factory-fitted optional equipment. The limitation of optional equipment is intended to ensure that the minimum pay-mass, i.e. the legally prescribed free mass for baggage and retrofitted accessories, is actually available for the vehicle load capacity of the vehicles delivered by Laika.

The real weight of your vehicle ex works can only be determined

when it is weighed at the end of the line. If, in exceptional cases, the weighing shows that the actual load capacity falls below the minimum pay-mass despite limiting the optional equipment due to a permissible weight deviation, we will check together with your trade partner and you whether we should, for example, increase the load capacity of the vehicle, reduce the number of seats or remove optional equipment before delivering the vehicle. **The technically permissible maximum laden mass** of the vehicle and the **technically permissible maximum mass on the axle** must not be exceeded.

Detailed information & explanations on the subject of weight and the configuration of the vehicle can be found in the section Legal information. For a more detailed description of all mandatory technical dependencies, please refer to the explanations on the footnotes on p. 20.

# ECOVIP CAMPER VAN

## OVERVIEW OF ALL MODELS

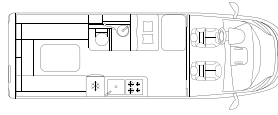

### MODELS

### 645

Standard chassis <sup>(46)</sup>		Fiat Ducato 35 Light
Engine displacement /maximum power	cc / kW (hp)	2184 / 103 (140)
External length / width / height <sup>(A)</sup>	cm	636 / 205 / 270
Internal width / height	cm	195 / 190
Wheelbase	mm	4.035
Technically permissible maximum laden mass*	kg	3.500
Mass in running order*	kg	2.903 (2.758 - 3.048)*
Permitted number of seats (including driver)*		4 (S)
Manufacturer-specified mass for optional equipment*	kg	238
Technically permissible maximum towable mass* <sup>(E) (F)</sup>	kg	2.500
Berths		2 (S)
Windows		6 (S) + 1 (O)
70 x 50 cm panoramic roof-light in living area		S
40 x 40 cm roof-light in sleeping area		S
Fresh water tank capacity, total / Fresh water tank capacity at driving filling <sup>(D)</sup>	l	100 / 20
Maximum waste water tank capacity depending on configuration and actual load	l	90
Toilet with removable tank (antifreeze)	l	18
Rear right side bed / rear left side bed	cm	192x60 / 175x60
Double rear bed	cm	196x192 max / 175 min
Bed on pop-top roof	cm	-
Refrigerator	l	90
Hot air channeled heating system	kW	6 Diesel
12 V socket - 230 V sockets	pcs.	1 / 2
USB socket	pcs.	2+2
Storage space for gas cylinder with max. 11 kg filling weight	pcs.	-
Storage space for gas cylinder with max. 5 kg filling weight	pcs.	2

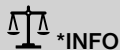

The specified **mass in running order** is a default value defined in the type-approval procedure. Due to manufacturing tolerances, the actual weighed mass in running order may deviate from the value stated above. Deviations of up to  $\pm 5\%$  of the mass in running order are legally permissible and possible. The permissible range in kilograms is given in brackets after the mass in running order. **The manufacturer-specified mass for optional equipment** is a calculated value for each type and layout that Laika uses to determine the maximum weight available for factory-fitted optional equipment. The limitation of optional equipment is intended to ensure that the minimum pay-mass, i.e. the legally prescribed free mass for baggage and retrofitted accessories, is actually available for the vehicle load capacity of the vehicles delivered by Laika.

The real weight of your vehicle ex works can only be determined

when it is weighed at the end of the line. If, in exceptional cases, the weighing shows that the actual load capacity falls below the minimum pay-mass despite limiting the optional equipment due to a permissible weight deviation, we will check together with your trade partner and you whether we should, for example, increase the load capacity of the vehicle, reduce the number of seats or remove optional equipment before delivering the vehicle. **The technically permissible maximum laden mass** of the vehicle and the **technically permissible maximum mass** on the axle must not be exceeded.

Detailed information & explanations on the subject of weight and the configuration of the vehicle can be found in the section Legal information. For a more detailed description of all mandatory technical dependencies, please refer to the explanations on the footnotes on p. 20.

## ECOVIP CAMPER VAN PACKS

### CHASSIS PACK

**2GA**  
+ 2,6 KG\*

- Steering wheel radio controls
- DAB radio antenna
- DAB car radio and speaker arrangement in cab
- Traction+, Hill Descent

Price

700 €

### DRIVING ASSISTANCE SYSTEMS PACK

**2PP**  
+ 0,2 KG\*

- Autonomous Emergency Brake Control with Pedestrian and Cyclist detection, Lane Control (Lane Support System), Rain and Dusk Sensor , Traffic Sign Recognition + High Beam Recognition

Price

950 €

### CHASSIS DESIGN PACK

**PDN**  
+ 1 KG\*

- Glossy black engine grille
- Leather-covered steering wheel and gear knob, original Fiat
- Headlights with black design surround
- Dashboard in "Techno Trim" version

Price

620 €

### COMFORT PACK ECOVIP CV

**2CY**  
+ 18 KG\*

- Mosquito net for side door
- Rear view camera preparation
- Insulated waste water tank
- Heated waste water tank
- Left-hand side rear window
- LED light and side door drip tray
- Shower footboard
- Kitchen upgrade: folding side shelf, illuminated open compartments on entrance side

Price

2.450 €

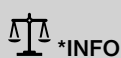

The factory installation of optional equipment increases the actual mass of the vehicle and reduces the pay-mass. The additional weight indicated for packages and optional equipment shows the additional weight compared to the standard equipment of the respective model or layout.

The total weight of the selected optional equipment must not exceed the **manufacturer-specified mass for optional equipment** shown in the model overviews. This is a calculated value for each

type and layout that Laika uses to determine the maximum weight available for factory-fitted optional equipment. Detailed information and explanations on the subject of weight can be found in the Legal information section.

For a more detailed description of all mandatory technical dependencies, please refer to the explanations on the footnotes on p. 20.



### ALARM PACK CAMPER VAN

**P5S**  
+ 3,8 KG\*

- Parking sensors front (4 pieces)
- Rear parking sensors (4 pcs.)
- Volumetric-perimeter anti-theft device (incl. garage doors and hatches), remote control integrated in engine key

Price

1.560 €

### MULTIMEDIA PACK KREOS

**MZ1**  
+ 7,8 KG\*

- Multimedia System 9", DAB car radio, Touchscreen, Navigation and map update 3 years, speakers, rear view camera <sup>(29)</sup> <sup>(41)</sup>

Price

2.230 €

### DIGITAL PACK CAMPER VAN

**PDC**  
+ 4 KG\*

- 10" Radio UConnect, Full Digital Cluster, Rear digital camera FIAT <sup>(28)</sup> <sup>(29)</sup>

Price

2.630 €

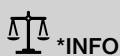

The factory installation of optional equipment increases the actual mass of the vehicle and reduces the pay-mass. The additional weight indicated for packages and optional equipment shows the additional weight compared to the standard equipment of the respective model or layout.

The total weight of the selected optional equipment must not exceed the **manufacturer-specified mass for optional equipment** shown in the model overviews. This is a calculated value for each

type and layout that Laika uses to determine the maximum weight available for factory-fitted optional equipment. Detailed information and explanations on the subject of weight can be found in the Legal information section.

For a more detailed description of all mandatory technical dependencies, please refer to the explanations on the footnotes on p. 20.

# ECOVIP CAMPER VAN ACCESSORIES

Code No.	Accessories	Price €	Kg*	540	600	645
3051266	Fiat Ducato Heavy Chassis 3,500 kg*	1.240 €	40 kg	-	0	0
<b>CHASSIS AND CAB</b>						
632+6WH	"Metallic Black" metallic cab paint	1.040 €	0 kg	0	0	0
385+3YM	"Lanzarote Grey" cab paint	1.040 €	0 kg	0	0	0
676+9YB	"Expedition Grey" cab paint	1.040 €	0 kg	0	0	0
3389509	Fiat 2.2 Engine, 180 BHP, Euro 6d Final (Extra charge compared to 140	3.450 €	20 kg	-	0	0
3350311	Fiat 2.2 Engine, 140 BHP, Heavy Duty (Extra charge compared to 140 BHP)	1.390 €	0 kg	0	-	0
3389514	Fiat 2.2 Engine, 180 BHP, Heavy Duty (Extra charge compared to 140 BHP) <sup>(3)</sup>	3.520 €	20 kg	-	-	0
2JH-5	Automatic transmission for 140 BHP engine - Light chassis <sup>(30)</sup>	3.290 €	55 kg	0	0	0
2JH-6	Automatic transmission for 180 BHP engine - Light chassis <sup>(30)</sup>	3.290 €	35 kg	-	0	0
AT9-HE140B	140 BHP Automatic gearbox for Heavy Chassis	3.290 €	18 kg	-	0	0
AT9-HE180B	180BHP Automatic gearbox for Heavy Chassis	3.290 €	3 kg	-	0	0
XAN	Blind Spot Assist + Rear Cross Path Detection <sup>(16)</sup>	630 €	1 kg	0	0	0
320	Steering wheel and gear knob in genuine leather, Fiat original part	330 €	0,3 kg	0	0	0
5QD	Engine battery cut off switch, Fiat original part	200 €	0 kg	0	0	0
3065127	Diesel tank 90 l, Fiat chassis	90 €	12 kg	0	0	0
FO7	Laika logo stickers for Fiat wheel covers or alloy wheels (4 pieces)	50 €	0,1 kg	0	0	0
431-2	16" Alloy wheels, Fiat original parts, 35 Light chassis (4 pieces)	620 €	0 kg	0	0	0
0R2-2	16" Alloy wheels black matte, Fiat original parts, 35 Light chassis (4 pieces)	710 €	0 kg	0	0	0
1LR	16" Alloy wheels Fiat original parts, Heavy chassis (4 pieces)	620 €	0 kg	0	0	0
LPZ	Fog lights with cornering function, Fiat original part	300 €	2 kg	0	0	0
LM1	LED daytime running lights, original Fiat	460 €	0 kg	0	0	0
9WE	Full LED headlights, Fiat original part	1.710 €	0 kg	0	0	0
026	Electric parking brake, Fiat original part	520 €	0 kg	0	0	0
67333	Automatic cab air conditioning, Fiat original part	440 €	0 kg	0	0	0
RFX	Wireless charger for mobile phones - Fiat original part <sup>(47)</sup>	560 €	0 kg	0	0	0
365	TPMS tyre pressure checking system	240 €	0,5 kg	0	0	0
2064193	Rear double-blade suspensions, Fiat original parts	110 €	0 kg	0	0	0
C93	Internal sliding blind for windshield and cab windows	580 €	4,5 kg	0	0	0
508	Rear parking sensors (4 pieces)	330 €	0 kg	0	0	0
341	Automatically folding exterior mirrors	270 €	1 kg	0	0	0
GRG	9" Digital rear-view mirror	1.830 €	0,5 kg	0	0	0
FH7	Carpeted driver's cabin	240 €	3 kg	0	0	0

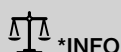

The factory installation of optional equipment increases the actual mass of the vehicle and reduces the pay-mass. The additional weight indicated for packages and optional equipment shows the additional weight compared to the standard equipment of the respective model or layout. The total weight of the selected optional equipment must not exceed the **manufacturer-specified mass for optional equipment** shown in the model overviews. This is a calculated value for each type and layout that Laika uses to determine the maximum weight available for factory-fitted optional equipment. Detailed information and explanations on the subject

of weight can be found in the Legal information section.

An increase of load capacity increases the manufacturer-specified mass for optional equipment. The increase results from the higher pay-mass due to the alternative chassis. The increased tare weight of the alternative chassis and, in particular, the weight for any mandatory heavier engine variants (e.g. 180 hp) must be deducted from this.

For a more detailed description of all mandatory technical dependencies, please refer to the explanations on the footnotes on p. 20.

Code No.	Accessories	Price €	Kg*	540	600	645
<b>INTERIOR ACCESSORIES</b>						
TFP	White pop-top roof with comfort double bed <sup>(4) (B) (C)</sup>	3.830 €	150 kg	O	O	-
TPG	Painted pop-top roof with comfortable double bed <sup>(4) (10) (B) (C)</sup>	4.500 €	150 kg	O	O	-
X8	Furniture design "Pero Toscano"	0 €	0 kg	O	O	O
TT4	Upholstery Siena	270 €	0 kg	O	O	O
EE	Upholstery Firenze, leatherette	610 €	0 kg	O	O	O
TT2	Upholstery Udine, leatherette	620 €	0 kg	O	O	O
TT5	Upholstery Milano, real leather	2.660 €	0 kg	O	O	O
T07	Cushions Lazio	380 €	0 kg	O	O	O
T04	Cushions Liguria	380 €	0 kg	O	O	O
T16	Cushions Roma	380 €	0 kg	O	O	O
T10	Cushions Trentino	430 €	0 kg	O	O	O
T03	Cushions Umbria	430 €	0 kg	O	O	O
T05	Cushions Veneto	430 €	0 kg	O	O	O
T17	Cushions Siena	360 €	0 kg	O	O	O
T19	Cushions Firenze, leatherette	380 €	0 kg	O	O	O
T02	Cushions Sardegna, leatherette	380 €	0 kg	O	O	O
T18	Cushions Milano, real leather	670 €	0 kg	O	O	O
C47	Preparations for 12V TV cable and TV bracket	290 €	3 kg	O	O	O
C72	19" TV LED DVD, with decoder and TV stand	880 €	8 kg	O	O	O
FS5	19" TV LED DVD, with decoder and TV stand at rear area	880 €	8 kg	-	-	O
FB3	Upgrade from Combi 6 to Combi 6 E heating	400 €	3 kg	O	O	-
D19	Upgrade from Combi Diesel to Combi Diesel E heating	470 €	3 kg	-	-	O
D42	Upgrade from Combi 6 to Combi Diesel heating <sup>(23)</sup>	610 €	1 kg	O	O	-
FH6	Upgrade from Combi 6 to Combi Diesel E heating <sup>(25)</sup>	1.260 €	5 kg	O	O	-
FM9	Compressor fridge 138 l <sup>(31)</sup>	1.180 €	11 kg	-	O	O
C78	Additional battery 90 Ah	430 €	26 kg	O	O	O
FL2	Gas detection system	200 €	2 kg	O	O	O

## EXTERIOR ACCESSORIES

FM7	Skyview <sup>(8)</sup>	1.330 €	5 kg	O	O	O
C77	Electrically operated entrance step	430 €	11 kg	O	O	O
2837302	Tow hitch	1.050 €	50 kg	O	O	O
F33	Gas regulator with automatic switchover + defrosting device (DuoControl + EisEX)	380 €	5 kg	O	O	O
D39	Bicycle rack for 2 bikes	530 €	9,5 kg	O	O	O
0C4	Awning Laika, 3,2 m, anthracite housing	920 €	24 kg	O	-	-
C83	Awning Laika, 3,7 m, anthracite housing	1.000 €	28,5 kg	-	O	-
FQ1	Awning Laika, 4,0 m, anthracite housing	1.090 €	30 kg	-	-	O
C79	Provision for solar panel <sup>(8)</sup>	130 €	2 kg	O	O	O

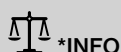

The factory installation of optional equipment increases the actual mass of the vehicle and reduces the pay-mass. The additional weight indicated for packages and optional equipment shows the additional weight compared to the standard equipment of the respective model or layout. The total weight of the selected optional equipment must not exceed the **manufacturer-specified mass for optional equipment** shown in the model overviews. This is a calculated value for each type and layout that Laika uses to determine the maximum weight available for factory-fitted optional equipment. Detailed information and explanations on the subject

of weight can be found in the Legal information section. An increase of load capacity increases the manufacturer-specified mass for optional equipment. The increase results from the higher pay-mass due to the alternative chassis. The increased tare weight of the alternative chassis and, in particular, the weight for any mandatory heavier engine variants (e.g. 180 hp) must be deducted from this. For a more detailed description of all mandatory technical dependencies, please refer to the explanations on the footnotes on p. 20.

# CAMPER VAN INFORMATION

## Mandatory, technical dependencies

- (4) When the pop-up roof is installed, the vehicle is not fitted with a roof window
- (8) Not compatible with pop-up roof
- (10) Metallic Black', 'Lanzarote Grey', 'Expedition Grey' paints are combined with the black pop-up roof
- (13) Engine Heavy Duty 180 HP only in combination with automatic transmission
- (16) Blind Spot Assist + Rear Cross Path Detection only in conjunction with Automatically folding exterior mirrors - Code 341
- (23) Combi Diesel heater only in conjunction with. Diesel heating, Code. 52X (standard for Ecovip Camper Van)
- (25) Combi Diesel E heater only in conjunction with. Diesel heating, Code. 52X (standard for Ecovip Camper Van)
- (28) Digital package only in conjunction with automatic climate control - Code 67333
- (29) Digital Package and Multimedia Package are incompatible
- (30) Automatic gearbox not compatible with 16" alloy wheels code 431-2 and OR2-2, instead 1-LR
- (31) Compressor fridge 138 l instead of wardrobe
- (40) Only for Ecovip 645
- (47) RFX - Wireless charger for mobile phones - Fiat original part - only in conjunction with code 67333 - Automatic cab air conditioning, Fiat original part

## Other technical notes

- (A) Accessories mounted on the roof ,for example satellite aerial, solar panel, etc., modify the height of the vehicle.
- (B) The total height increases by 25 cm when the folding roof is installed
- (C) The awning and folding roof combination reduces the awning length by 25 cm
- (D) Before driving, please ensure that the fresh water tank does not contain more than 20 l
- (E) Towed mass for climbs not exceeding 12% gradient
- (F) The maximum technically permissible trailer load and the total weight of the vehicle in running order must not exceed 6000kg.

## Notes on accessory equipment

Always follow the manufacturer's installation instructions and warnings when installing accessories.

## Technical notes

The information on weight, dimensions, equipment and configurations given in this document reflects the state of knowledge and production at the time of publication (August 2022).

The towing capacity specifications refer to a slope of no more than 12%. Laika reserves the right to modify or improve its products at any time. We recommend that you inform yourself on any changes to the standard equipment relative to the information given in this document before you purchase a vehicle from your Laika dealer.

The colours of individual components may vary due to different combinations of materials.

The total height of the vehicle will be increased by rooftop equipment such as satellite dishes and solar panels.

Any subsequent changes to the vehicle that affect its weight specifications are the responsibility of the owner. Please note that adding accessory equipment to the vehicle will reduce its loading capacity and affect the load on the axles.

## Miscellaneous notes

Laika Caravans S.p.A. reserves the right to change the technical properties of the body and chassis, the characteristics of the furnishings and the equipment of the vehicles presented in this price list at any time and without notice.

Despite careful controls, this price list may contain printing errors. Some of the vehicle images are photos of prototypes for which no final production version had been determined at the time of printing (January 2023).

We therefore recommend that you contact your Laika dealer, who will be happy to inform you of any deviations. Any changes may affect the design, materials, colours, shapes and equipment. Some of the vehicles photographed and presented in this price list have accessories that are not included as standard equipment and can therefore only be delivered at a surcharge.

The photos can also include furnishings, e.g. plates, glasses and other items such as TVs and surfboards, that are not included in the vehicles' equipment and are not distributed or offered by Laika. The equipment and characteristics shown in this price list are valid at the time of printing.

Your authorised Laika dealer will inform you of any changes made to the products subsequent to printing. All special equipment is subject to a surcharge.

Customised, special and/or specific uses must be communicated to the Laika dealer before the conclusion of the purchase contract.

## Notes on prices

The prices shown in this price list are recommended prices expressed in Euro, ex-works, quoted without VAT and without local taxes. This price list supersedes any previous versions.

# LEGAL NOTES ON WEIGHT-RELATED INFORMATION

The weight specifications and tests for motorhomes are uniformly regulated throughout the EU in EU Implementing Regulation No. 2021/535 (until June 2022: EU Implementing Regulation No. 1230/2012). We have summarised and explained the key terms and legal requirements from this regulation for you below. Our dealers and the Laika configurator on our website offer you additional assistance in configuring your vehicle.

## 1. Technically permissible maximum laden mass

The technically permissible maximum laden mass of the vehicle (e.g. 3,500 kg) is a mass specification set by the manufacturer which the vehicle must not exceed. Information on the technically permissible maximum laden mass of the model you have chosen can be found in the technical data. If the vehicle exceeds the technically permissible maximum laden mass in everyday driving, this constitutes an administrative offence which may result in a fine.

## 2. Mass in running order

In simple terms, the mass in running order is the basic vehicle with standard equipment plus a legally fixed standard weight of 75 kg for the driver. This essentially includes the following items:

- the unladen weight of the vehicle together with the bodywork, including operating fluids such as greases, oils and coolants;
- the standard equipment, i.e. all equipment items that are included as standard in the factory-fitted scope of delivery;
- the fresh water tank filled to 100 % in driving mode (driving fill according to manufacturer's specifications; 20 litres) and an aluminium gas cylinder filled to 100 % with a weight of 16 kg;
- the fuel tank, which is 90 % full, including fuel;
- the driver, whose weight – regardless of the actual weight – is generally specified as 75 kg in accordance with EU law.

Information on the **mass in running order** can be found for each model in our sales documents. It is **important** to note that the value for mass in running order given in the sales documents is a **default value** determined in the type-approval procedure and verified by the authorities. It is legally permissible and possible for the mass in running order of the vehicle delivered to you to deviate from the nominal value stated in the sales documents. The **legally permissible tolerance is ± 5 %**. In this way, the EU legislator accounts for the fact that certain fluctuations in the mass in running order occur due to variations in the weight of supplied parts as well as due to processes and weather conditions. These weight deviations can be illustrated by means of an example calculation:

- Mass in running order acc. to sales documents: 2,850 kg
- Legally permissible tolerance of ± 5 %: 142.50 kg
- Legally permissible range of mass in running order: 2,707.50 kg to 2,992.50 kg

The specific range of permissible weight deviations can be found for each model in the technical data. Laika makes great efforts to reduce weight variations to the minimum that is unavoidable for production reasons. Deviations at the upper and lower end of the range are therefore very rare; however, they cannot be completely ruled out technically, even with all optimisations. The real weight of the vehicle and compliance with the permissible tolerance is therefore checked by Laika by weighing each vehicle at the end of the line.

## 3. Mass of the passengers

The mass of the passengers is set a standard value of 75 kg for each seat provided by the manufacturer, regardless of the actual weight of the passengers. The mass of the driver is already included in the mass in running order (see no. 2 above) and is therefore not included again. In the case of a motorhome with four permitted seats, the mass of the passengers is therefore  $3 * 75 \text{ kg} = 225 \text{ kg}$ .

## 4. Optional equipment and actual mass of the vehicle

**Optional equipment** (also: additional equipment) includes, according to the legal definition, all **optional equipment** parts not included in the standard equipment which are fitted to the vehicle under the responsibility of the manufacturer – i.e. ex works – and can be ordered by the customer (e.g. awning, bicycle or motorbike carrier, satellite system, solar system, oven, etc.). Information on the individual or package weights of the optional equipment that can be ordered can be found in our sales documents. Optional equipment in this sense does not include other accessories that are retrofitted by the dealer or you personally after the vehicle has been delivered ex works.

The mass of the vehicle in running order (see no. 2 above) and the **mass of the optional equipment** fitted to a specific vehicle at the factory are together referred to as the actual mass. You will find the corresponding information for your vehicle after handover under item 13.2 of the Certificate of Conformity (CoC). Please note that this specification also represents a **standardised value**. Since the mass in running order – as an element of the actual mass – is subject to a legally permissible tolerance of ± 5 % (see no. 2), the actual mass may also deviate accordingly from the stated nominal value.

## 5. Pay-mass and minimum pay-mass

The installation of optional equipment is also subject to technical and legal limits: Only so much optional equipment can be ordered and fitted at the factory that sufficient free weight remains for baggage and other accessories ("pay-mass") without exceeding the technically permissible maximum laden mass. The pay-mass is calculated by subtracting the mass in running order (nominal value according to sales documents, see no. 2 above), mass of the optional equipment and the mass of the passengers (see no. 3 above) from the technically permissible maximum laden mass (see no. 1 above). The EU regulations stipulate a fixed minimum pay-mass for motorhomes, which must remain as a minimum for baggage or other non-factory-fitted accessories. This minimum pay-mass is calculated as follows:

Minimum pay-mass in kg  $\geq 10 * (n + L)$

Where: "n" is the maximum number of passengers plus the driver and "L" is the overall length of the vehicle in metres.

For a motorhome with a length of 6 m and 4 approved seats, the minimum pay-mass is therefore e.g.  $10 \text{ kg} * (4 + 6) = 100 \text{ kg}$ .

To ensure that the minimum pay-mass is maintained, there is a maximum combination of optional equipment that can be ordered for each vehicle model. In the above example with a minimum pay-mass of 100 kg, the total mass of optional equipment for a vehicle with four permitted seats and a mass in running order of 2,850 kg should not exceed 325 kg:

**3,500 kg technically permissible maximum laden mass**

- 2,850 kg mass in running order
- 3\*75 kg mass of the passengers
- 100 kg minimum pay-mass

**= 325 kg maximum permissible mass of optional equipment**

It is important to note that this calculation is based on the default value for mass in running order as defined in the type-approval procedure, without taking into account the permissible weight deviations for mass in running order (see no. 2 above). If the maximum permissible value for the optional equipment of (in the example) 325 kg is almost or completely exhausted, an upward weight deviation can therefore result in the minimum pay-mass of 100 kg being met mathematically using the default value for the mass in running order, although in fact there is no corresponding load capacity. Here, too, an example calculation for a vehicle with four seats, whose real weighed mass in running order is 2 % above the nominal value:

**3,500 kg technically permissible maximum laden mass**

- 2,907 kg real weighed mass in running order  
(+ 2 % compared to the stated value of 2,850 kg)
- 3\*75 kg mass of the passengers
- 325 kg optional equipment (maximum permissible value)

**= 43 kg actual load capacity (< minimum pay-mass of 100 kg)**

In order to avoid such a situation, Laika further reduces the maximum permissible weight of the total optional equipment that can be ordered on a model-specific basis. The limitation of optional equipment is intended to ensure that the minimum pay-mass, i.e. the legally prescribed free mass for baggage and retrofitted accessories, is actually available for the vehicle load capacity of the vehicles delivered by Laika.

Since the weight of a specific vehicle can only be determined when it is weighed at the end of the line, in very rare cases a situation may arise in which the minimum pay-mass at the end of the line is not guaranteed, despite this limitation of optional equipment. In order to guarantee the minimum pay-mass even in these cases, Laika will check together with your trade partner and you before delivery of the vehicle whether, for example, the vehicle is loaded up, seats are reduced or optional equipment is removed.

**6. Effects of tolerances of the mass in running order on the pay-mass**

Regardless of the minimum pay-mass, you should note that unavoidable production-related fluctuations in the mass in running order – both upwards and downwards – have a mirror-image effect on the remaining load capacity: If you order our example vehicle (see no. 3. above), for example, with optional equipment with a total weight of 150 kg, the calculated pay-mass based on the default value for the mass in running order is 275 kg. The load capacity actually available may deviate from this value due to tolerances and may be higher or lower. If the mass in running order of your vehicle is, for example, permissibly 2 % higher than stated in the sales documents, the load capacity is reduced from 275 kg to 218 kg:

**- 3.500 kg technically permissible maximum laden mass**

- 2.907 kg real weighed mass in running order  
(+ 2 % compared to the stated value of 2,850 kg)
- 3\*75 kg mass of the passengers
- 150 kg optional equipment ordered for the specific vehicle

**= 218 kg actual load capacity**

As a precaution to ensure that the calculated pay-mass is actually given, you should therefore take the possible and permissible tolerances for the mass in running order into account when configuring your vehicle.

We also recommend that you weigh the laden motorhome on a non-automatic scale before each journey and, taking the individual weight of the passengers into account, determine whether the technically permissible maximum laden mass and the technically permissible maximum mass on the axle are observed.

Laika Caravans S.p. A.  
Via Certaldese 41/A  
San Casciano in Val di Pesa  
50026 Firenze, Italia

Telefono: +39 055 805 81

laika@laika.it  
www.laika.it

Facebook: LaikaCaravan

Instagram: laika\_Caravans

EU-EST

Enjoy the Dolce Vita.

